

Model LM

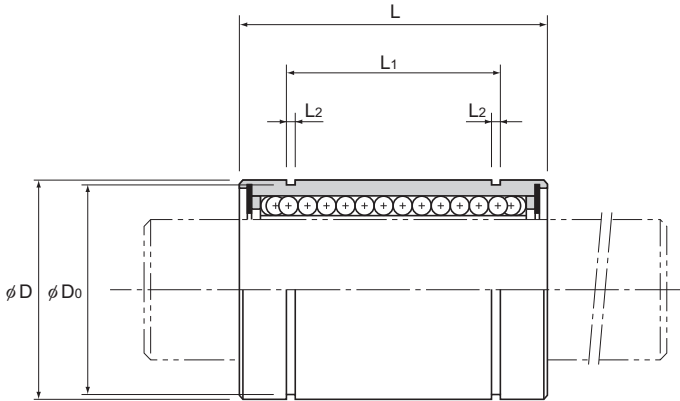

| Model No. | | | Ball rows | Main | | | | | | |
|---------------|---------------------------|-----------|-----------|------|-------------------------|--------|----------------|--------------------------|--------|-----------|
| Standard type | Clearance-adjustable type | Open type | | dr | Inscribed bore diameter | | Outer diameter | | Length | |
| | | | | | Precision | High | D | Tolerance Precision/high | L | Tolerance |
| LM 3 | — | — | 4 | 3 | 0 | 0 | 7 | 0 | 10 | 0 |
| LM 4 | — | — | 4 | 4 | | | 8 | | 12 | |
| LM 5 | — | — | 4 | 5 | | | 10 | | 15 | |
| LM 6 | LM 6-AJ | — | 4 | 6 | 0 | 0 | 12 | 0 | 19 | 0 |
| LM 8S | LM 8S-AJ | — | 4 | 8 | | | 15 | | 17 | |
| LM 8 | LM 8-AJ | — | 4 | 8 | | | 15 | | 24 | |
| LM 10 | LM 10-AJ | — | 4 | 10 | | | 19 | | 29 | |
| LM 12 | LM 12-AJ | LM 12-OP | 4 | 12 | | | 21 | | 30 | |
| LM 13 | LM 13-AJ | LM 13-OP | 4 | 13 | | | 23 | | 32 | |
| LM 16 | LM 16-AJ | LM 16-OP | 5 | 16 | 28 | 37 | 0 | | | |
| LM 20 | LM 20-AJ | LM 20-OP | 5 | 20 | 32 | 42 | | | | |
| LM 25 | LM 25-AJ | LM 25-OP | 6 | 25 | 40 | 59 | | | | |
| LM 30 | LM 30-AJ | LM 30-OP | 6 | 30 | 0 | 0 | 45 | 0 | 64 | 0 |
| LM 35 | LM 35-AJ | LM 35-OP | 6 | 35 | | | 52 | | 70 | |
| LM 40 | LM 40-AJ | LM 40-OP | 6 | 40 | -0.008 | -0.012 | 60 | -0.019 | 80 | -0.3 |
| LM 50 | LM 50-AJ | LM 50-OP | 6 | 50 | | | 80 | | 100 | |
| LM 60 | LM 60-AJ | LM 60-OP | 6 | 60 | 0 | 0 | 90 | 0 | 110 | 0 |

Note) Since this model contains a synthetic resin retainer, do not use it at temperature exceeding 80°C.
 If the ambient temperature exceeds 80°C, use the type equipped with a metal retainer (model LM-GA).
 If requiring a type equipped with a seal, indicate it when placing an order.
 (Example) LM13 UU

Seal attached on both ends of the nut

For the clearance-adjustable type (-AJ) and open type (-OP), the inscribed bore diameter tolerance, the outer diameter tolerance, and the eccentricity indicate the values before the division of the nut.

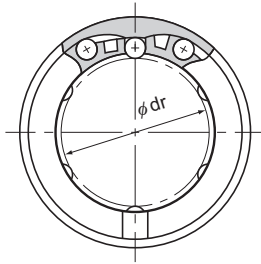

Model LM

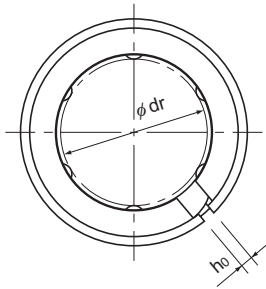

Model LM-AJ

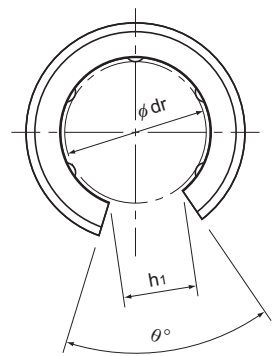

Model LM-OP

Unit: mm

| | dimensions | | | | | | | Eccentricity (max) | | Radial clearance tolerance μm | Basic load rating | | |
|------|----------------|-----------|----------------|----------------|----------------|----------------|----|--------------------|------|----------------------------------|-------------------|---------------------|-----------|
| | L ₁ | Tolerance | L ₂ | D ₀ | h ₀ | h ₁ | θ° | μm | | | C N | C ₀ N | Mass g |
| | | | | | | | | Precision | High | | | | |
| — | — | — | — | — | — | — | — | 4 | 8 | -2 | 88.2 | 108 | 1.4 |
| — | — | — | — | — | — | — | — | 4 | 8 | -3 | 88.2 | 127 | 1.9 |
| 10.2 | 0 -0.2 | — | 1.1 | 9.6 | — | — | — | 4 | 8 | -3 | 167 | 206 | 4 |
| 13.5 | | — | 1.1 | 11.5 | 1 | — | — | 8 | 12 | -5 | 206 | 265 | 8 |
| 11.5 | | — | 1.1 | 14.3 | 1 | — | — | 8 | 12 | -5 | 176 | 225 | 11 |
| 17.5 | | — | 1.1 | 14.3 | 1 | — | — | 8 | 12 | -5 | 265 | 402 | 16 |
| 22 | | — | 1.3 | 18 | 1 | — | — | 8 | 12 | -5 | 373 | 549 | 30 |
| 23 | | — | 1.3 | 20 | 1.5 | 8 | 80 | 8 | 12 | -5 | 412 | 598 | 31.5 |
| 23 | | — | 1.3 | 22 | 1.5 | 9 | 80 | 8 | 12 | -7 | 510 | 775 | 43 |
| 26.5 | | — | 1.6 | 27 | 1.5 | 11 | 60 | 8 | 12 | -7 | 775 | 1180 | 69 |
| 30.5 | | — | 1.6 | 30.5 | 1.5 | 11 | 60 | 10 | 15 | -9 | 863 | 1370 | 87 |
| 41 | | 0 -0.3 | — | 1.85 | 38 | 2 | 12 | 50 | 10 | 15 | -9 | 980 | 1570 |
| 44.5 | — | | 1.85 | 43 | 2.5 | 15 | 50 | 10 | 15 | -9 | 1570 | 2750 | 250 |
| 49.5 | — | | 2.1 | 49 | 2.5 | 17 | 50 | 12 | 20 | -13 | 1670 | 3140 | 390 |
| 60.5 | — | | 2.1 | 57 | 3 | 20 | 50 | 12 | 20 | -13 | 2160 | 4020 | 585 |
| 74 | — | | 2.6 | 76.5 | 3 | 25 | 50 | 12 | 20 | -13 | 3820 | 7940 | 1580 |
| 85 | — | | 3.15 | 86.5 | 3 | 30 | 50 | 17 | 25 | -16 | 4710 | 10000 | 2000 |

Note) When using the Linear Bushing on a single shaft, use two or more units (instead of one unit) on the same shaft to avoid a moment load, and secure a large distance between the units.

If an oil hole is required, this can be indicated by appending "OH" to the end of the model number.

For further information, contact THK.